

REV.	DATE	DESCRIPTION
NC	06/05/03	INITIAL RELEASE

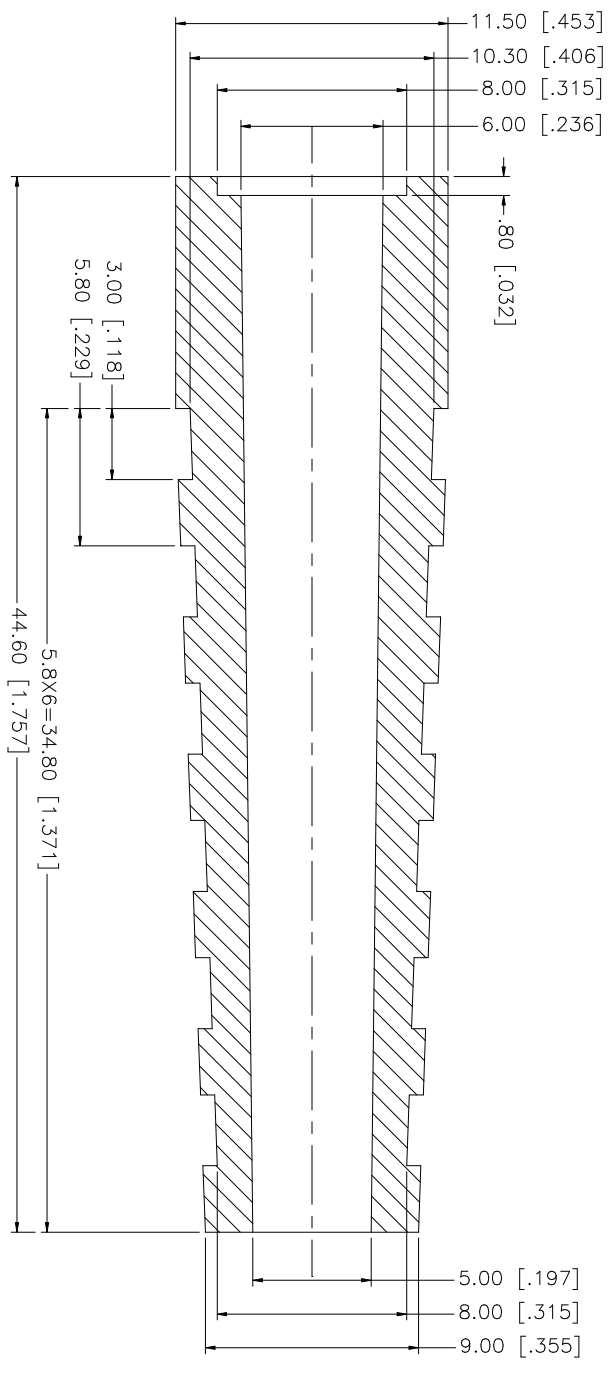

8																				
7																				
6																				
5																				
4																				
3																				
2																				
1																				
	DESCRIPTION	MATERIAL	FINISH	QTY																
	STRAIN RELIEF	PVC	OPTIONAL	1																

UNLESS OTHERWISE SPECIFIED, DIMENSIONS ARE IN MILLIMETERS. DIMENSIONS IN [ ] ARE IN INCHES AND FOR CUSTOMER REFERENCE ONLY.		UNLESS OTHERWISE SPECIFIED, TOLERANCES FOR ALL DIMENSIONS ARE:	
0.5 - 8mm	± 0.20mm	0.5 - .315	± 0.007"
8 - 30mm	± 0.40mm	.315 - 1.180	± 0.015"
30 - 120mm	± 0.50mm	1.180 - 4.724	± 0.020"
UNLESS OTHERWISE SPECIFIED, TOLERANCES FOR DIMENSIONS ARE:		DO NOT SCALE DRAWING	
APPROVALS		DATE	
DRAWN	G.R.S.	06/05/03	
CHECKED			
ISSUED			
SHEET	1 OF 1		
CAD FILE		C:/MISC/60015-000.DWG	
PART DESCRIPTION		PART NO.	
STRAIN RELIEF BOOT -58U		60015-000	
DWG. NO.	60015-000.DWG	REV.	NC
SIZE	A	SCALE	NA

**Amphenol Connex**