

Part No.	Cable color
~088*1~	GRAY
~088*2~	BLACK
~088*3~	WHITE

NOTE ① We indicate the length of the harness on the last of product name. 'L' part.

② Tolerance for [L]

Length L [mm]	Tolerance [mm]
$35 \leq L \leq 200$	± 4
$200 < L \leq 500$	± 8
$500 < L \leq 1000$	± 12
$1000 < L$	$\pm 1.5\%$

③ Connector rotation angle is within ± 45 degree from the above image. For long length in the case of $L > 500$, the angle is optional.

4. Specifications are subject to change without notice.

【 DIMENSIONS OF CONNECTOR 】

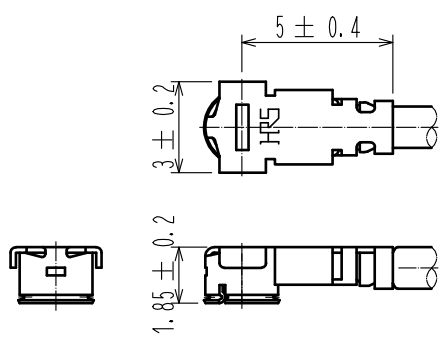

1	U.FL-LP-088	CL331-0454-0	2	1.37 Dia. coaxial cable
NO.	PART NO.	CODE NO.	NO.	PART NO.

UNITS mm		SCALE FREE	COUNT 	DESCRIPTION OF REVISIONS	DESIGNED	CHECKED	DATE
-------------	--	---------------	-----------	--------------------------	----------	---------	------

HIROSE ELECTRIC CO., LTD.	APPROVED	·NK. NINOMIYA	16.07.22	DRAWING NO.	U.FL-2LP-088**T-AC-L ①
	CHECKED	·MT. KANEKO	16.07.21	PART NO.	
	DESIGNED	·MS. MATSUMOTO	16.07.21	CODE NO.	
	DRAWN	·MS. MATSUMOTO	16.07.21	NO.	