

TOP VIEW

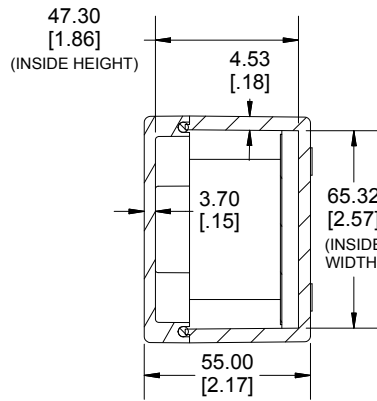

**SECTION B-B
END VIEW**

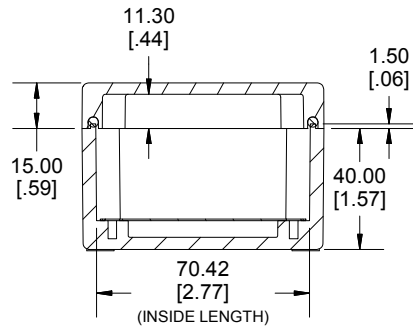
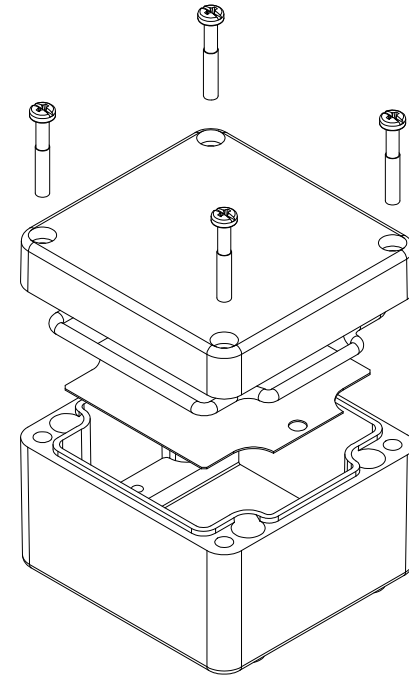

**SECTION A-A
SIDE VIEW**

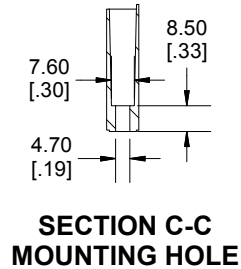
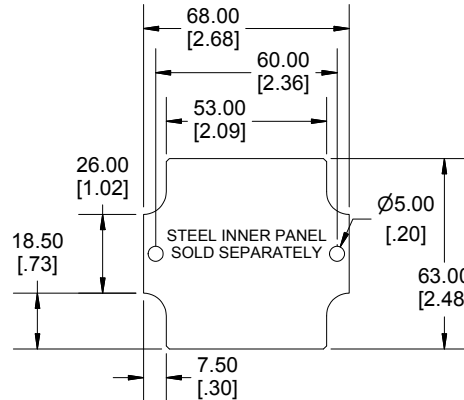

**SECTION C-C
MOUNTING HOLE**

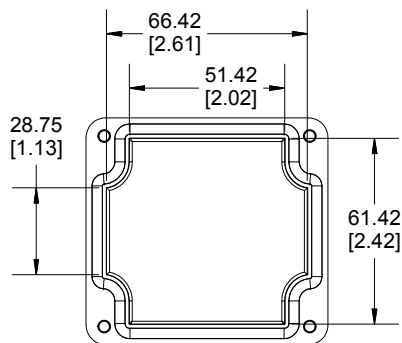

INSIDE LID

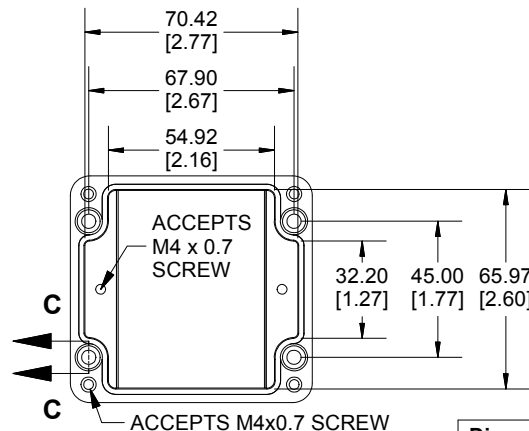

INSIDE BOX

Dimensions:
mm
[inches]



Enclosures can be Factory Modified (Milling, Drilling, Printing etc.)
Contact Factory mjm@hammondmfg.com for quotes
Solid models of this enclosure available in STEP or IGES.
(Part number and text placement/orientation on our products are subject to change,
we do not recommend using them as a locating reference for modification purposes)

NOTE

Purchased assembly includes Box, Lid, Gasket and 4 cover screws
Enclosure Molded from Glass Reinforced Polyester
Recommended cover screw torque 6-7.5 lbf.in (70-85 cN.m)

PART NUMBERS

1590ZGRP081 Enclosure	
Grey Enclosure	1590ZGRP081GY
ACCESSORIES	
Copper Ground Hardware (50 Pack) [M4 - 0.7 X 6mm / M4 Washer]	SCGM4-50
Stainless Steel Cover Screw (50 Pack) [M4 - 0.7 x 25mm]	SC583-50
Steel Inner Panel	1590ZGRP081PL
Hinge Kit (2 Pack)	1427HK

1590ZGRP081
www.hammondmfg.com