

# MUELLER®

**MODEL: BU-P2142**

**Mini Banana Jack**

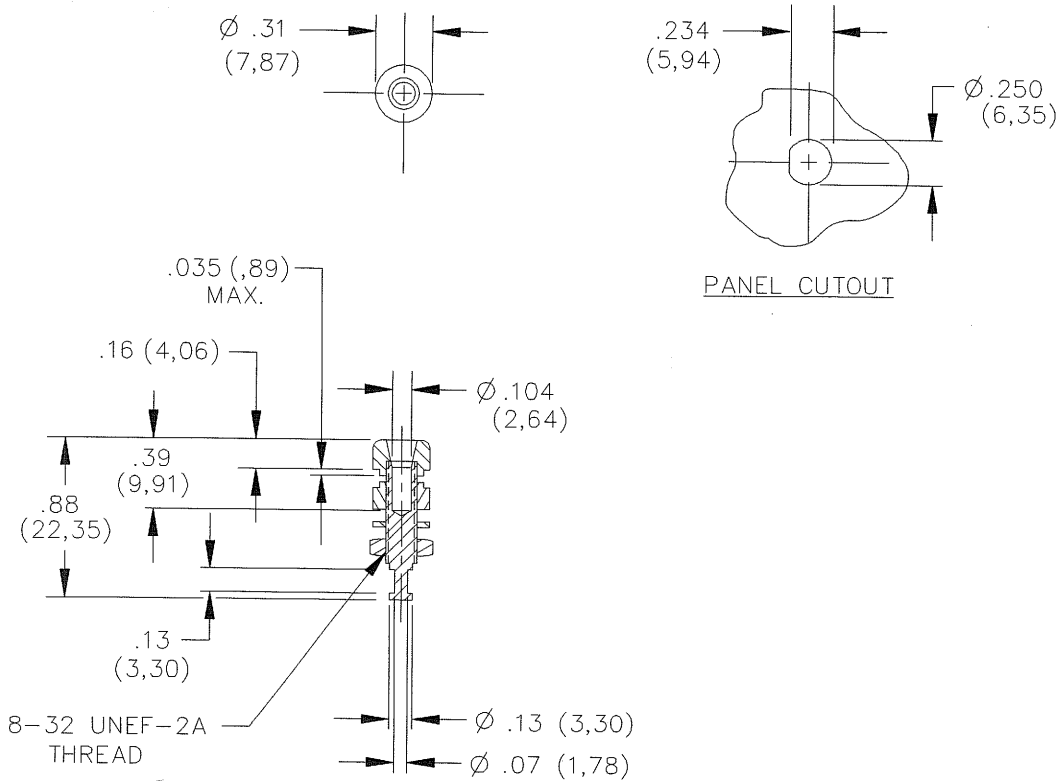

## MATERIALS:

Body – Nylon

Banana – Nickel Plated Brass

Standard Colors: -0 Black, -2 Red

Maximum panel thickness: .25" (6.35) Solder connection.

## RATING:

5 Amps

Hands free testing to 1000 VDC max.

Temperature: -50°C to 105°C