

LOC		DIST		REVISIONS			
P	LTN	DESCRIPTION	DATE	DMN	APVD		
A		RELEASED	13MAR2013	C.C.	I.Y.		

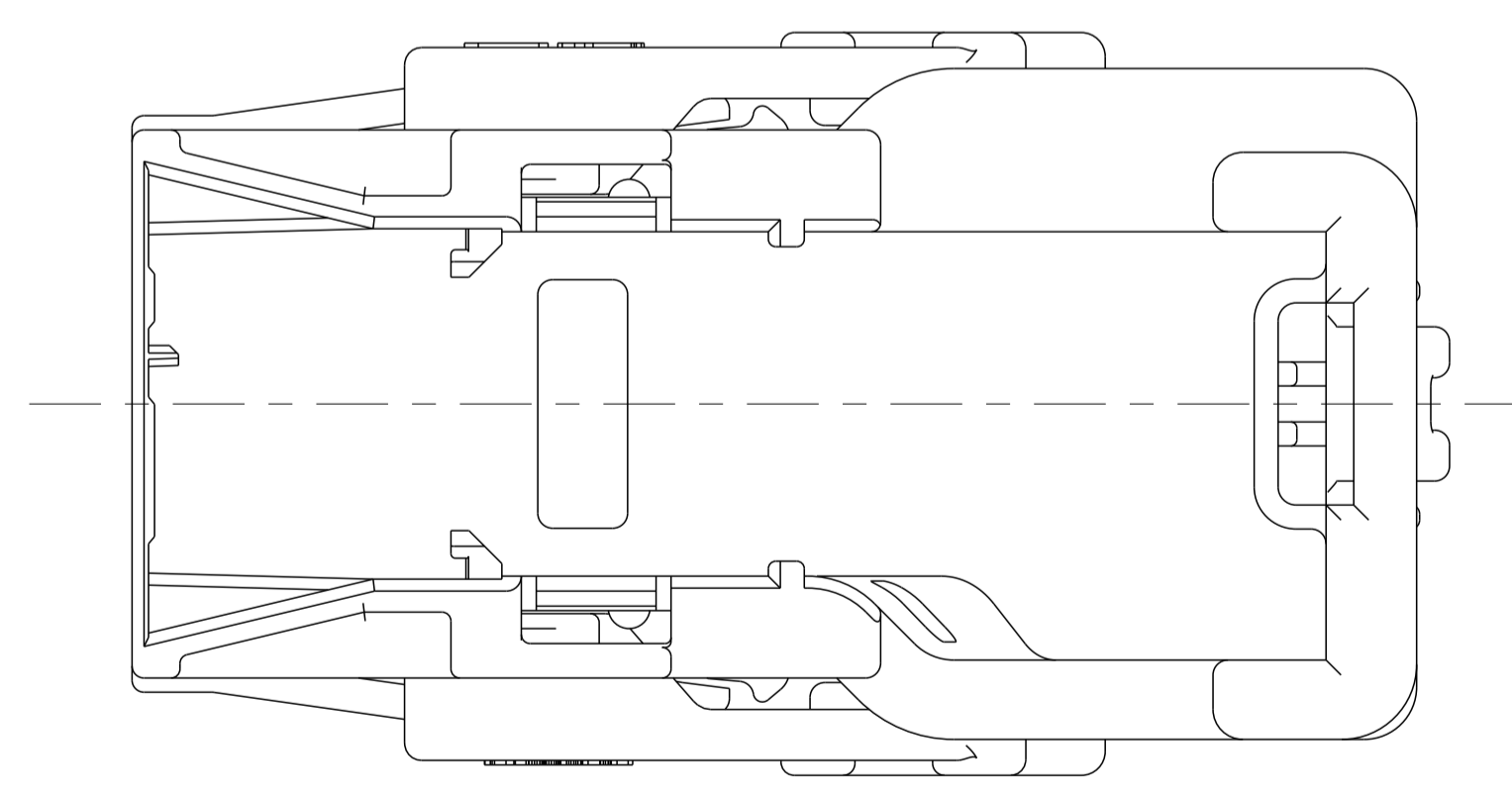
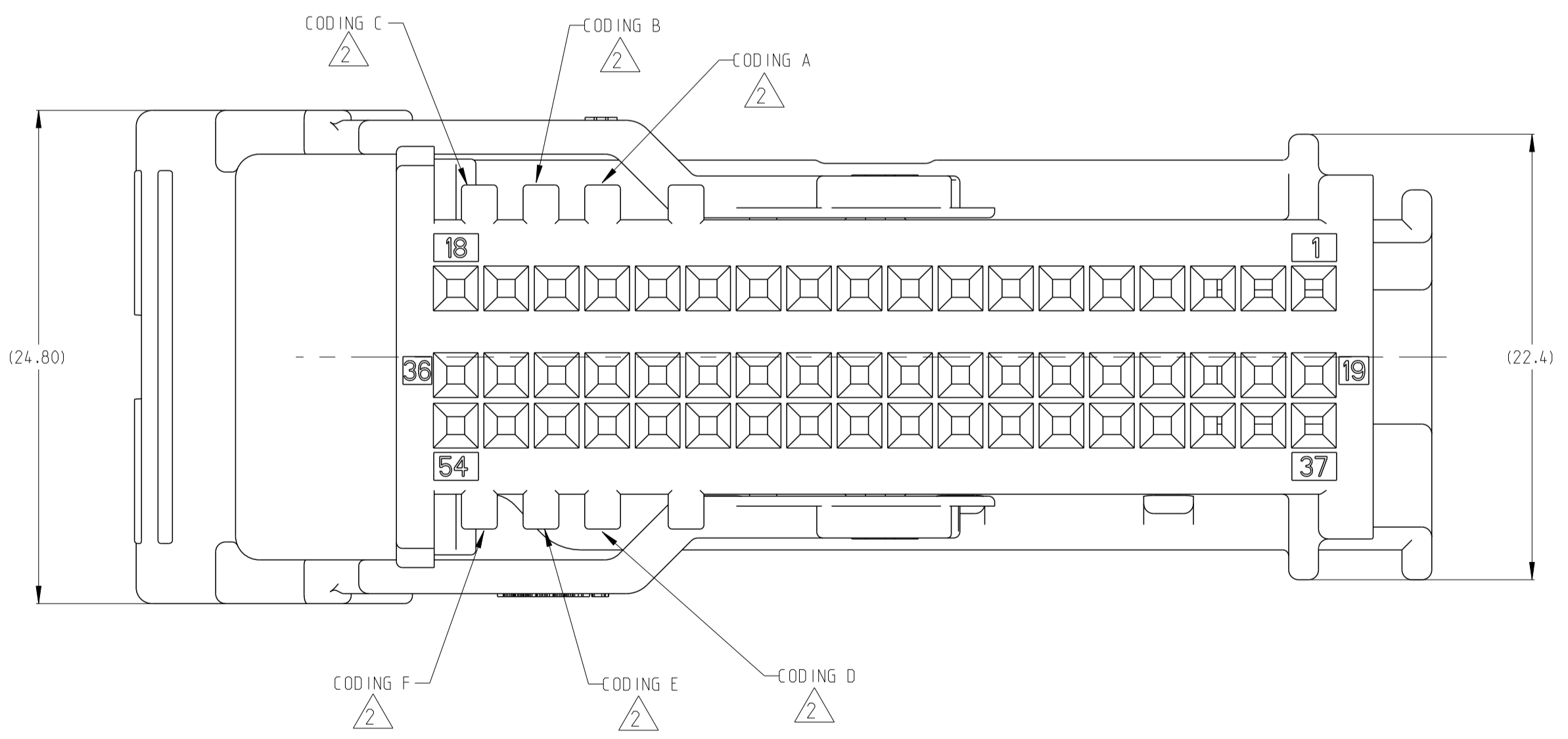
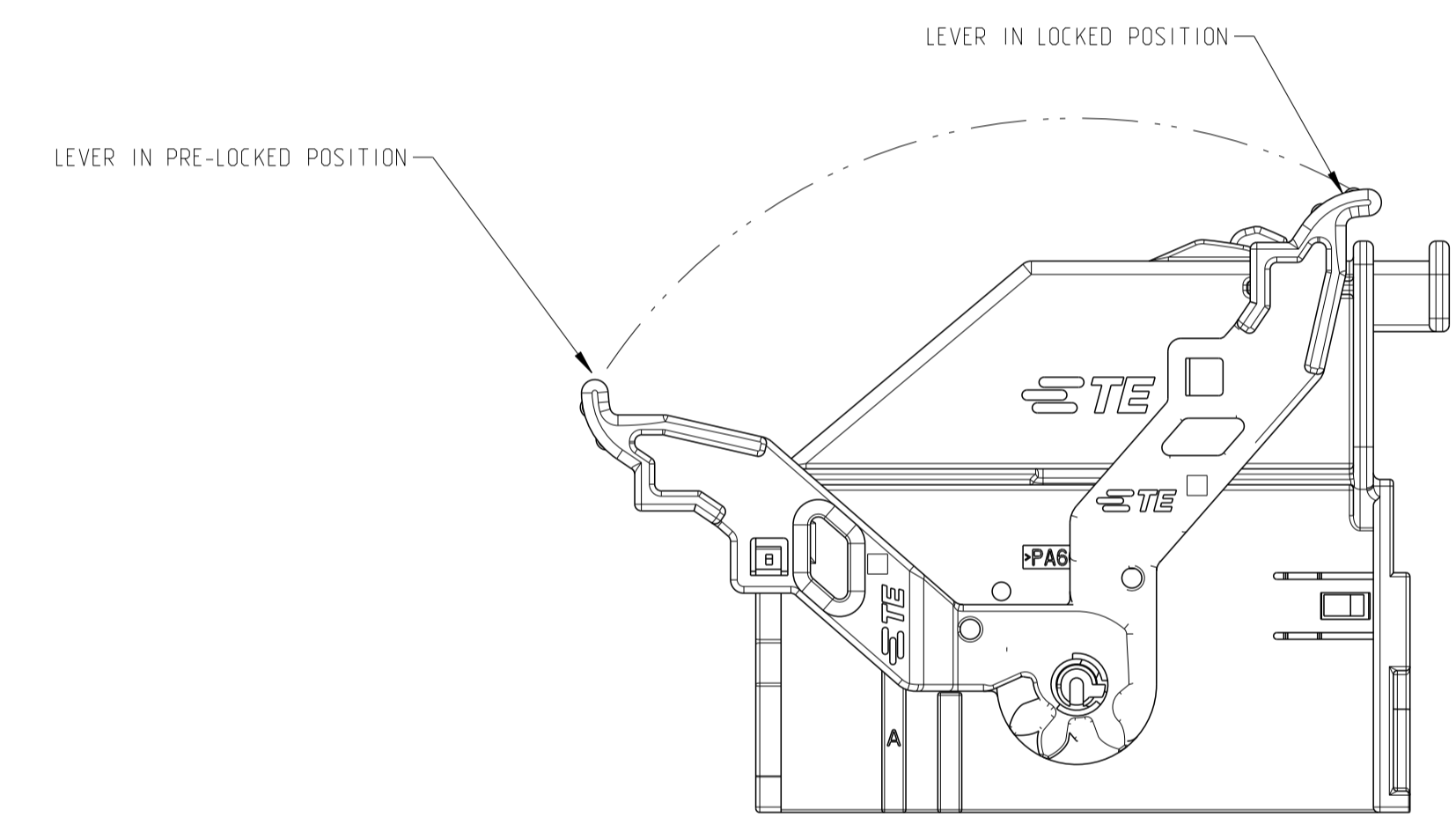
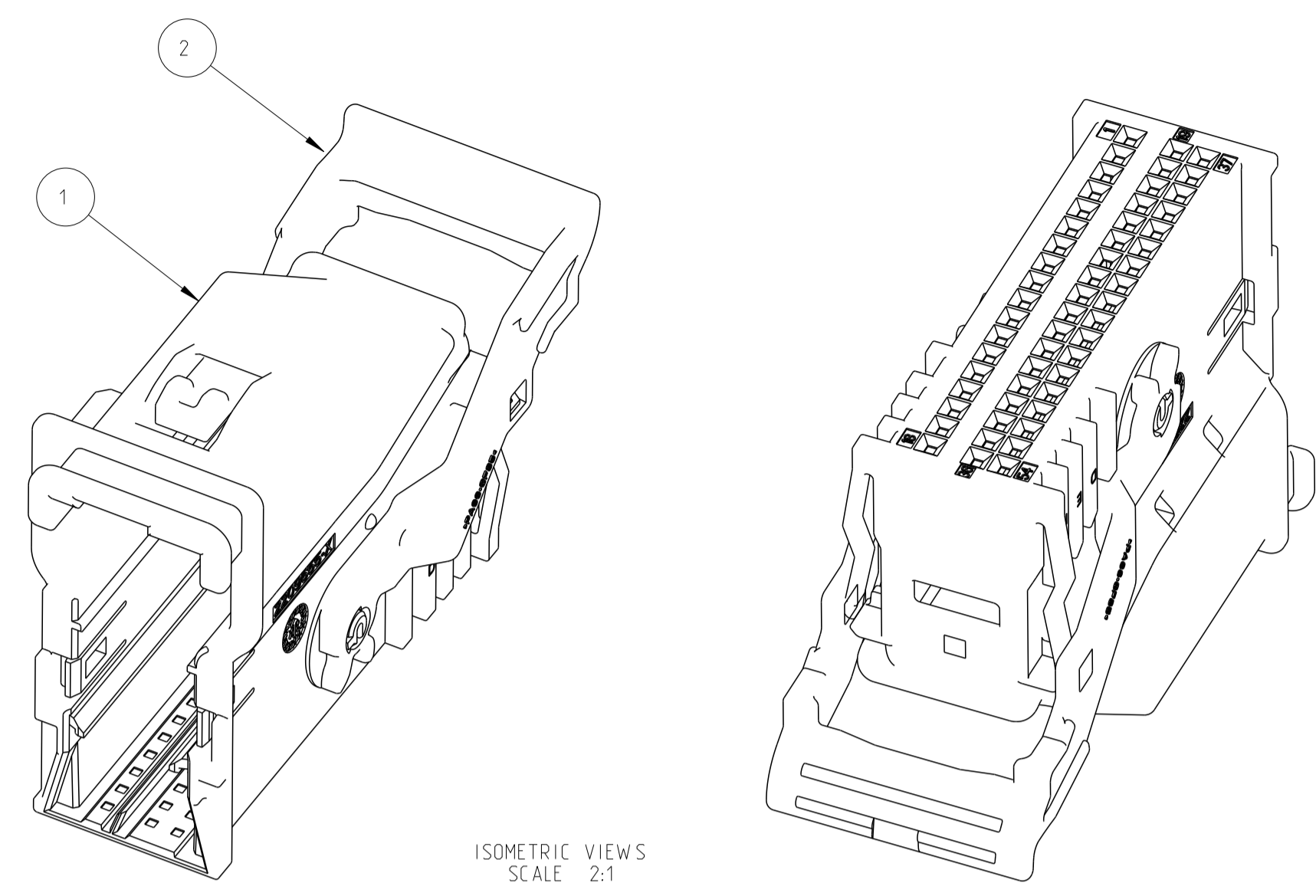
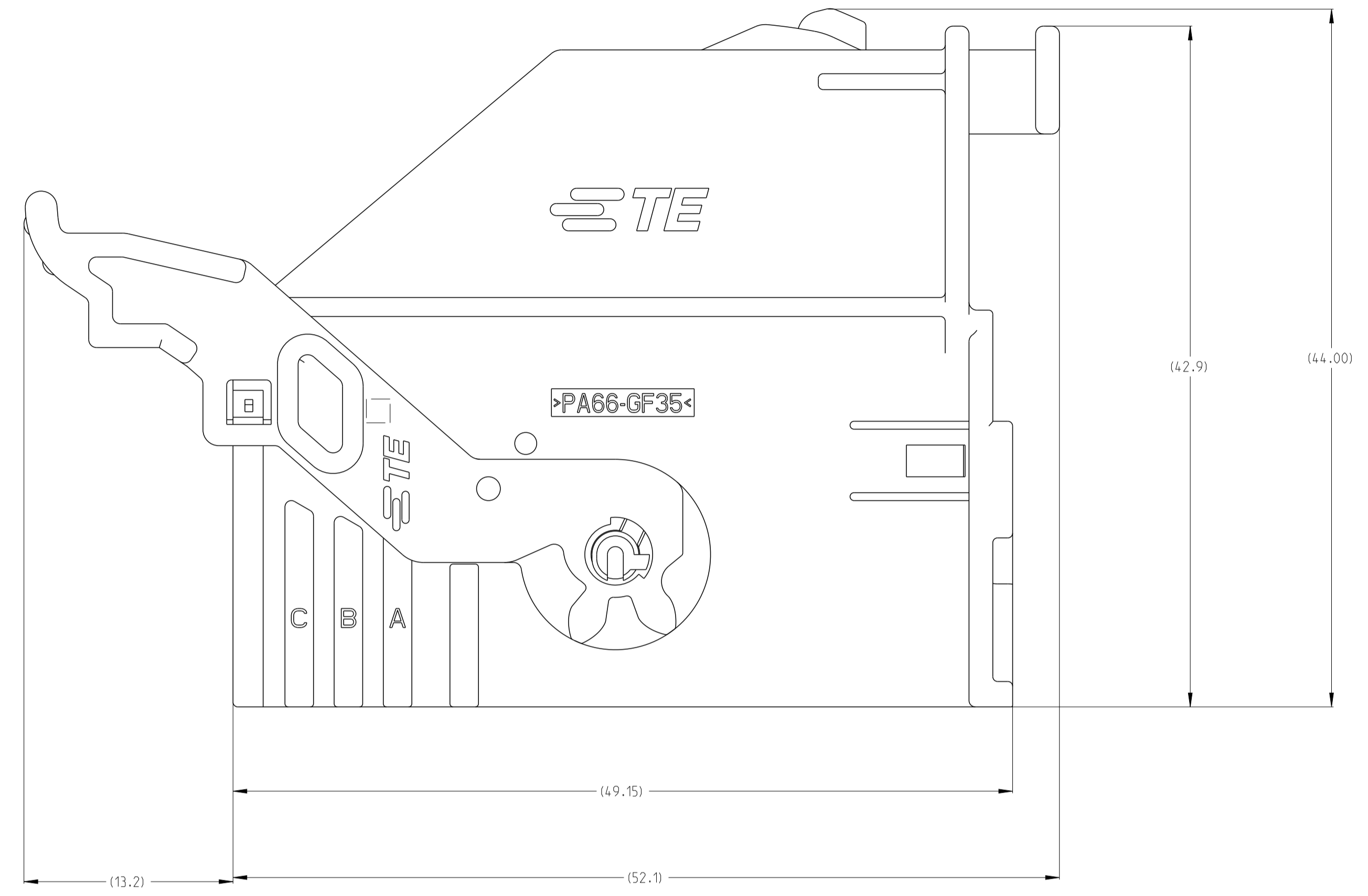

- NOTES:
- 1) WIRE COVER ASSEMBLY ACCEPTS CARRIER PART NUMBER 2098971-1 AND 2098972-1. CARRIER MUST BE ORDERED SEPARATELY AND BE ASSEMBLED TOGETHER BEFORE INSERTING INTO COVER.
  - 2) ALL CODINGS SHOWN FOR REFERENCE ONLY. SEE BELOW PART NUMBER TABLE FOR CODING.
  - 3) MAXIMUM WIRE LOADING: 54 TERMINALS CRIMPED TO 20 AWG WIRE WITH 1.60mm MAX OD INSULATION.
  - 4) REFER TO INSTRUCTION SHEET 408-8662 FOR PRODUCT ASSEMBLY AND DISASSEMBLY PROCEDURES.

QTY	UNIT	COLOR	MATERIAL	DESCRIPTION	PN	ITEM
1	1	GRAY	PA66-GF35	54P LEVER	2209656-1	2
1		YELLOW		54P COVER	2209655-2	1
	1				2209655-1	
2209652-2		2209652-1				
CODING CD		CODING AF				

THIS DRAWING IS A CONTROLLED DOCUMENT.

DIMENSIONS:	TOLERANCES UNLESS OTHERWISE SPECIFIED:	DMN	13MAR2013
mm	0 PLC ±0.5	CHK	13MAR2013
	1 PLC ±0.20	APVD	13MAR2013
	2 PLC ±		
	3 PLC ±		
	4 PLC ±		
	ANGLES ±#1°		
	FINISH		

MATERIAL: SEE TABLE

WEIGHT: -

CUSTOMER DRAWING

SCALE: 4:1

SHEET: 1 OF 1

REV: A

NAME: WIRE COVER ASSEMBLY 54 POSN. 0.64mm PLUG

SIZE: A1

CAGE CODE: 00779

DRAWING NO: 2209652

RESTRICTED TO: -