

Tous droits strictement réservés. Reproduction ou communication à des tiers interdites sans autorisation écrite de la Direction des Conception. Propriété de FCI. Droits de reproduction FCI.

FCI

All rights strictly reserved. Reproduction or communication to third parties in any form without the written authorization of the Design Director. Property of FCI. Copyright FCI.

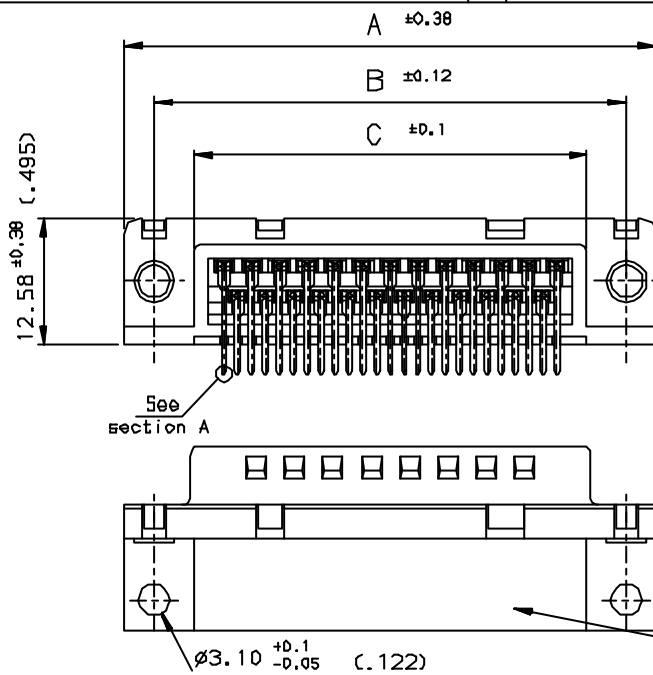

Part Number & Date Code Printing

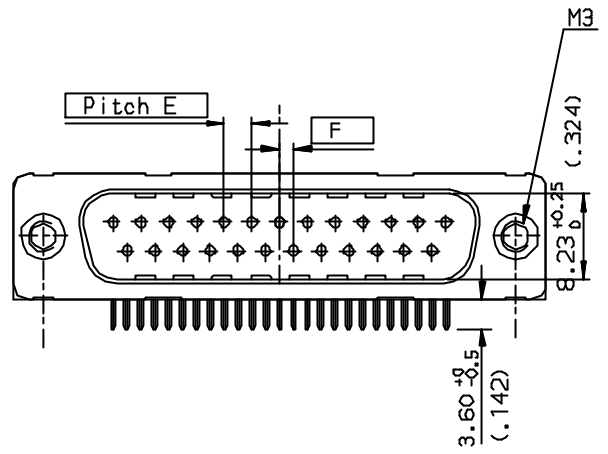

section A
Ech: 15

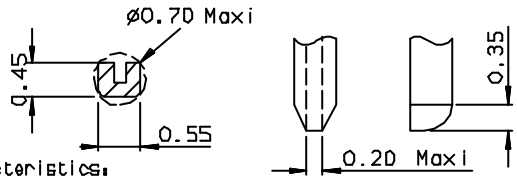

REQUIREMENTS

- Technical characteristics:**
 Shell: steel tin plated
 Insulators: self-extinguishing black polyester, UL Class 94V0
 Contacts size 20: phosphor bronze, 0.4µ min. gold on mating end, bright tin on termination end over nickel on entire contact
 Cycles > 500
 Nuts: brass, tin plated
- Electrical characteristics:**
 max. current rating: 5A
 Test voltage: 1000V
 Rated voltage: 300V
 Contact resistance: <15mΩ
 Shell resistance: <5mΩ
 Insulation resistance: >5000MΩ
- Climatic characteristics:**
 Operating temperature range: -55°C +125°C
- Dimensions:**
 In accordance with MIL-C-24308
 inches are in parenthesis

Code	A ±0.38	B ±0.12	C ±0.10	D +0.25/0	E	F	G +0.15/0	PART NUMBER	PART NUMBER SIEMENS
09	(1.213) 30.81	(.983) 24.99	(.667) 16.95	(.661) 16.79	(.108) 2.74	(.0539) 1.37	(.232) 5.90	D09P43F5PL00**	
15	(1.541) 39.14	(1.312) 33.32	(.991) 25.18	(.989) 25.12	(.108) 2.74	(.0539) 1.37	(.232) 5.90	D15P43F5PL00**	295 998
25	(2.088) 53.03	(1.852) 47.04	(1.540) 39.12	(1.529) 38.84	(.109) 2.76	(.0545) 1.38	(.224) 5.70	D25P43F5PL00**	296 004
37	(2.750) 69.32	(2.500) 63.50	(2.192) 55.68	(2.177) 55.30	(.109) 2.76	(.0545) 1.38	(.224) 5.70	D37P43F5PL00**	296 012

LF FOR LEAD FREE

FOR ROHS DETAILS REFER DNG. NO: C01-8646-0000

Dr JOHN SLEIBA		01/9/02	Product Family	D-SUB	Tolerance LINEAR ±0.1 ANGULAR ±1°	Projection	MM
Eng GEORGE VJ		01/9/02	Spec ref		Size	A3	Scale
Chr GEORGE VJ		27/7/05	Material		ECN		
Appr K Somasundaram		27/7/05					
Title PIN CONNECT.SUB right angled split with nut, plastic bracket			Dng no C01-8646-0093		Rev. F		
Catalog no		DELTA-D		CUSTOMER COPY		Sheet 1 of 1	

f	DATE	REVISION DESCRIPTION
1	27/7/05	LEAD FREE DETAILS ADDED

Utr	Eon no	Dr	date
F	105-0124	J5	27/7/05