

CODINGS

COLOR: WHITE
P/N*: N/A

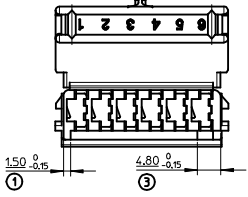

COLOR: GREEN
P/N*: N/A

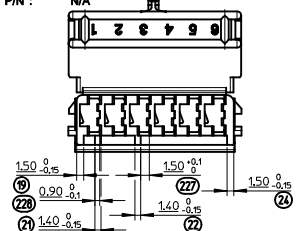

COLOR: BLACK
P/N*: 09889361061

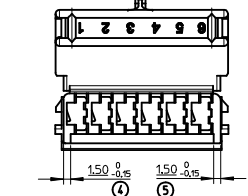

COLOR: BLUE
P/N*: N/A

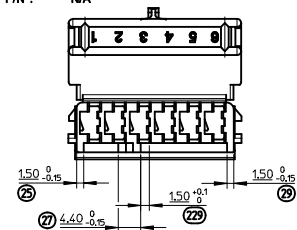

COLOR: RED
P/N*: 09889361062

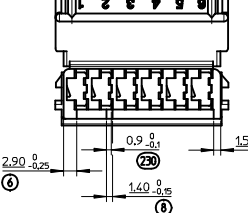

COLOR: PURPLE
P/N*: N/A

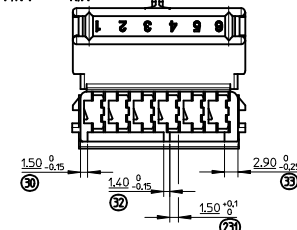

COLOR: ORANGE
P/N*: N/A

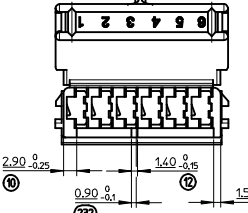

COLOR: GREY
P/N*: N/A

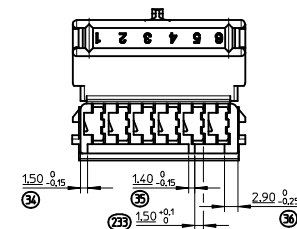

COLOR: YELLOW
P/N*: 09889361064

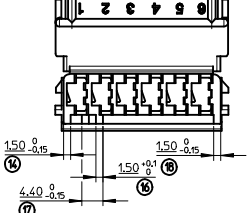

COLOR: BROWN
P/N*: 09889361069

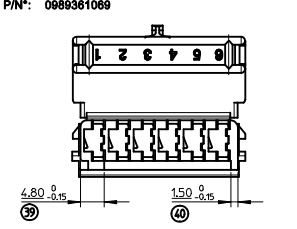

BROWN	0989361069	6CKT RCPT HSG	PA6.6
GREY	N/A		
PURPLE	N/A		
BLUE	N/A		
GREEN	N/A		
YELLOW	0989361064		
ORANGE	N/A		
RED	0989361062		
BLACK	0989361061		
WHITE	N/A		
COLOR	P/N*	DESCRIPTION	MATERIAL

CAVITIES SPECIFICATIONS		
CRIMPING	WIRE (SECTION MM2)	INSULATION (Ø EXT. MM)
SINGLE WIRE	3MM2 MAX.	4MM MAX.
TWIN	SIDE BY SIDE 1MM2 + 1.4MM2	2.7MM + 3MM MAX.
WIRES	TOP & DOWN 0.6MM2 + 2 MM2	2.4MM + 3.2MM

NOTES:
DIMENSIONS TO BE CHECKED ON STABILIZED PARTS WITH 2.5% ±0.5% OF WATER.

ISO VIEWS

CLOSED

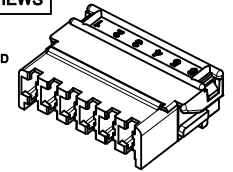

OPEN

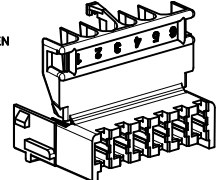

TERMINALS TO BE USED			
P/N's	TYPE OF TERMINAL	MATERIAL	SECTION (MM2)
0988901014	CSP Term.		0.35 TO 1 MM2 REDUCED INSULATION
0988951014	VDL Term.	CuZn15	
0988952014	VDL Term.	CuSn	
0988901011	CSP Term.		0.35 TO 1 MM2
0988951011	VDL Term.	CuZn15	
0988952011	VDL Term.	CuSn	
0988901012	CSP Term.		1 TO 3 MM2
0988951012	VDL Term.	CuZn15	
0988951012	VDL Term.	CuSn	

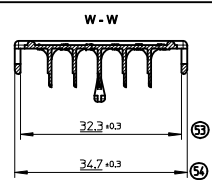
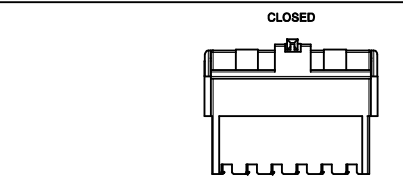

- MARKINGS:**
- 1- TERMINALS CAVITIES NUMBERING (OUTSIDE)---HEIGHT = 2MM---IN RELIEF 0.2MM
 - 2- TERMINALS CAVITIES NUMBERING (INSIDE)---HEIGHT = 3MM---IN RELIEF 0.2MM
 - 3- SUPPLIER ACRONYM:-----IN RELIEF 0.2MM
 - 4- DRAWING REVISION LEVEL:---2 MARKS,-----IN RELIEF 0.2MM
 - 5- SERIES NUMBER:-----HEIGHT = 1MM---IN RELIEF 0.2MM
 - 6- MOLD CAVITY NUMBER:-----HEIGHT = 2MM---IN RELIEF 0.2MM
 - 7- MOLD NUMBER:-----HEIGHT = 2MM---IN RELIEF 0.2MM

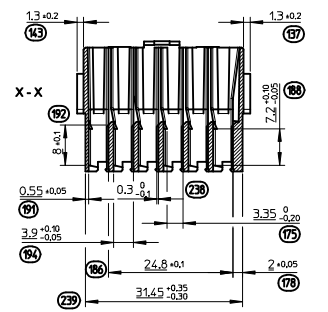
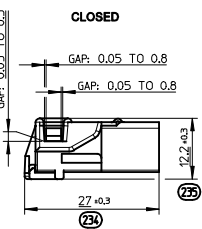
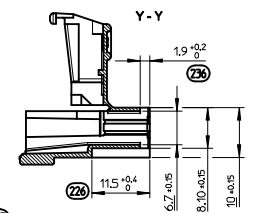
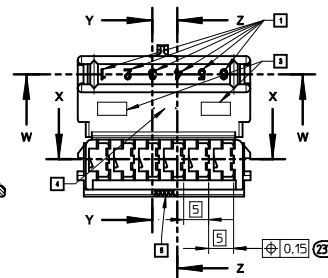
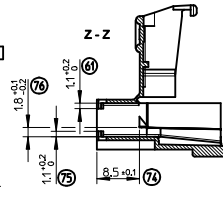
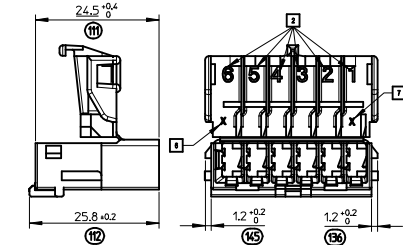

* INSPECTION NUMBERS FROM 1 TO 226 SPOTTED ON THE DRAWING ARE COMING FROM THE ENG. DWG.

REV.	FIRST	LAST	DELETED	SUPERSEDED
INSPECTION NUMBERS				

REVISED & REDRAWN
EC NO: G2003-0140
DRAWN: PLESSIS 2012/11/16
CHKD: JUCLOS 2012/11/16
APPR: PLESSIS 2012/11/22

QUALITY SYMBOLS	

GENERAL TOLERANCES (UNLESS SPECIFIED)	
mm	INCH
4 PLACES ±	±
3 PLACES ±	±
2 PLACES ±	±
1 PLACE ±	±
0 PLACE ±	±
ANGULAR ± 2°	
DRAFT WHERE APPLICABLE MUST REMAIN WITHIN DIMENSIONS	

DIMENSION STYLE	
MM ONLY	
DRAWN BY	DATE
GDESBRUERES	2012/06/04
CHECKED BY	DATE
JUCLOS	2012/11/16
APPROVED BY	DATE
OPLESSIS	2012/11/22

SCALE	DESIGN UNITS	FIRST ANGLE PROJECTION
2:1	METRIC	

6CKT CSP5 RCPT HSG	
molex	
DOCUMENT NO.	SHEET NO.
SD-98936-009	1 OF 1

REV.	MODIFICATIONS

-INCH GENERIC DRAWING FORMAT REDRAWN & UPDATED ON OSDM FILE FORMAT FOR MOLEX.
-DIM#186: 24.8±0.1 WAS 25±0.15