

MATERIALS AND FINISHES

BODY BRASS
PLATED NICKEL

CENTER CONTACT BRASS
PLATED GOLD

INSULATOR TEFLON

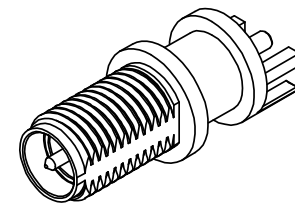

SMA JACK
REVERSE POLAR
INTERFACE

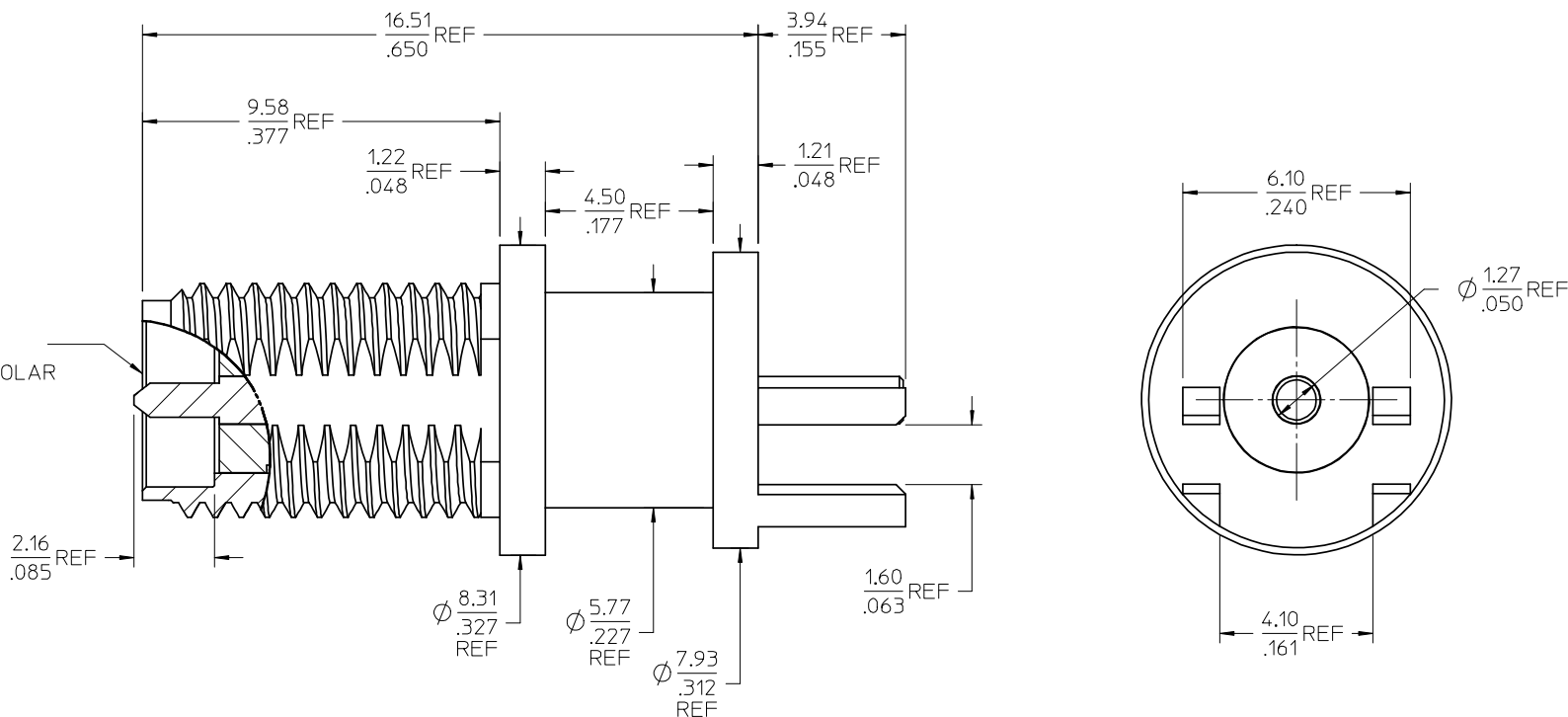

PART # 73251-2320

CHG: NEW RELEASE

EC NO: URF2008-0411 2008/02/08
 DRWN:SSHAH 2008/02/08
 CHKD:ROBERTSON 2008/02/08
 APPR:JWIENER 2008/02/08

QUALITY SYMBOLS
 ▼=0
 ▽=0

GENERAL TOLERANCES (UNLESS SPECIFIED)

	mm	INCH
4 PLACES	± .005	± .0005
3 PLACES	± .003	± .0003
2 PLACES	± .002	± .0002
1 PLACE	± .001	± .0001

ANGULAR ± 2°

DRAFT WHERE APPLICABLE
MUST REMAIN
WITHIN DIMENSIONS

DIMENSION STYLE
MM/IN

DRAWN BY DATE
AZR 2003/11/17

CHECKED BY DATE

APPROVED BY DATE

MATERIAL NO.
732512320

SIZE
C

SCALE
DESIGN UNITS
METRIC

THIRD ANGLE PROJECTION

TITLE
SMA JACK, EDGE MOUNT
50 OHMS, REVERSE POLAR
EWR-2237 SMA-J/RP/PCB

MOLEX MOLEX INCORPORATED

DOCUMENT NO.
SD-73251-232

SHEET NO.
1 OF 1