

LOC		DIST		REVISIONS			
CM	00	REV	DATE	BY	CHK	APPV	
N2		REVISED PER ECR-12-011660	31JAN13	KH	TM		

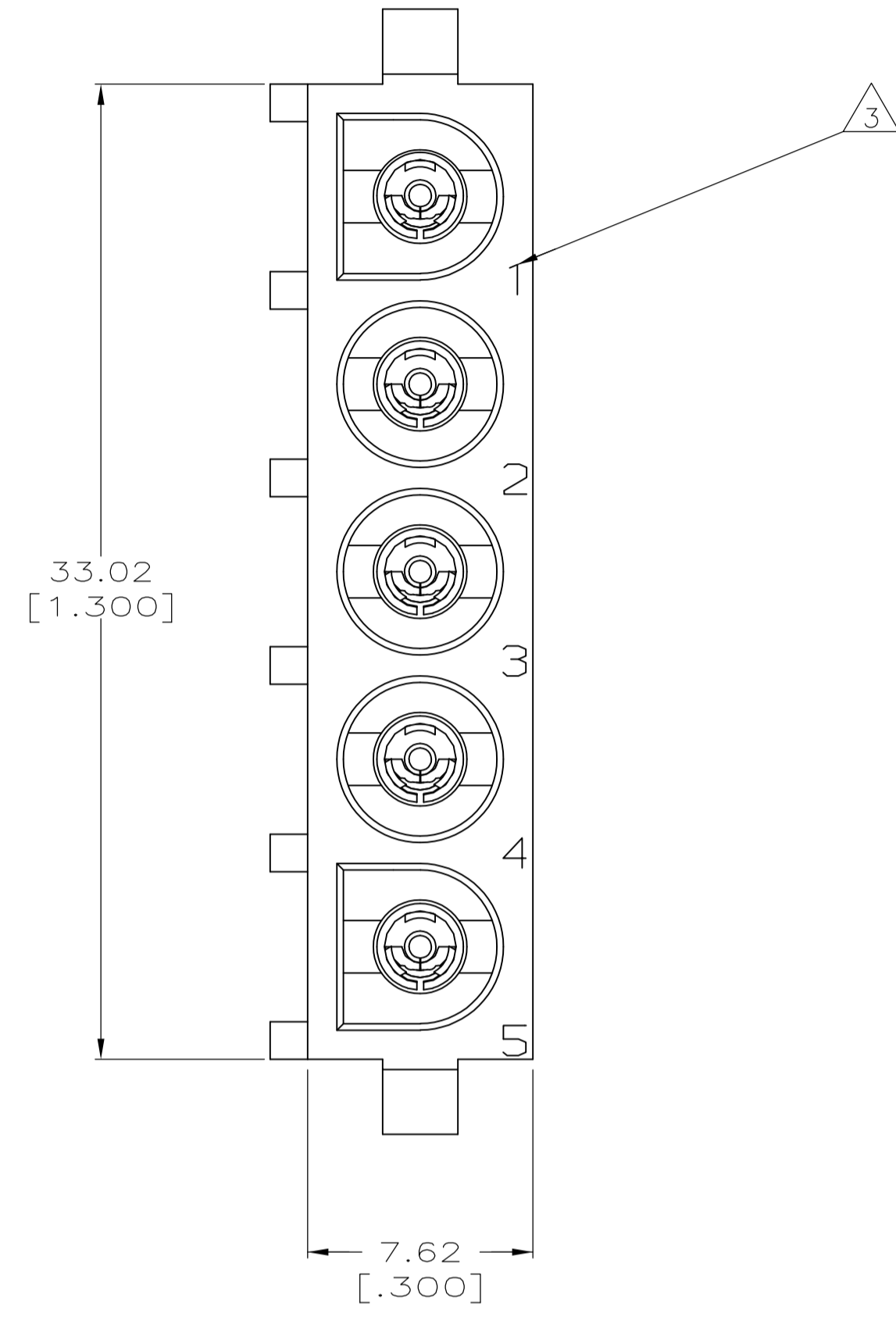

- 1 PARTS COMPLY TO AMP SOLDERABILITY SPECIFICATION 109-11-3.
- 2 CONTACT IS PLATED OVERALL WITH 0.00127 [.000050] NICKEL, THEN 0.00076 [.000030] GOLD OVER CONTACT LENGTH INDICATED AND MATTE TIN LEAD ON SOLDER TAIL END.
- 3 CIRCUIT IDENTIFICATION CHARACTERS ARE ADJACENT TO THE INDICATED CAVITIES, BUT LOCATION AND ORIENTATION MAY DIFFER FROM PRINT.
- 4 DIMENSIONS IN BRACKETS ARE IN INCHES.
- 5 CONTACT IS PLATED OVERALL WITH 0.00127 [.000050] NICKEL, THEN 0.00076 [.000030] GOLD OVER CONTACT LENGTH INDICATED AND MATTE TIN ON SOLDER TAIL END.
- 6 PRELIMINARY - NOT FOR PRODUCTION
- 7 SUPERSEDED BY 640901-3

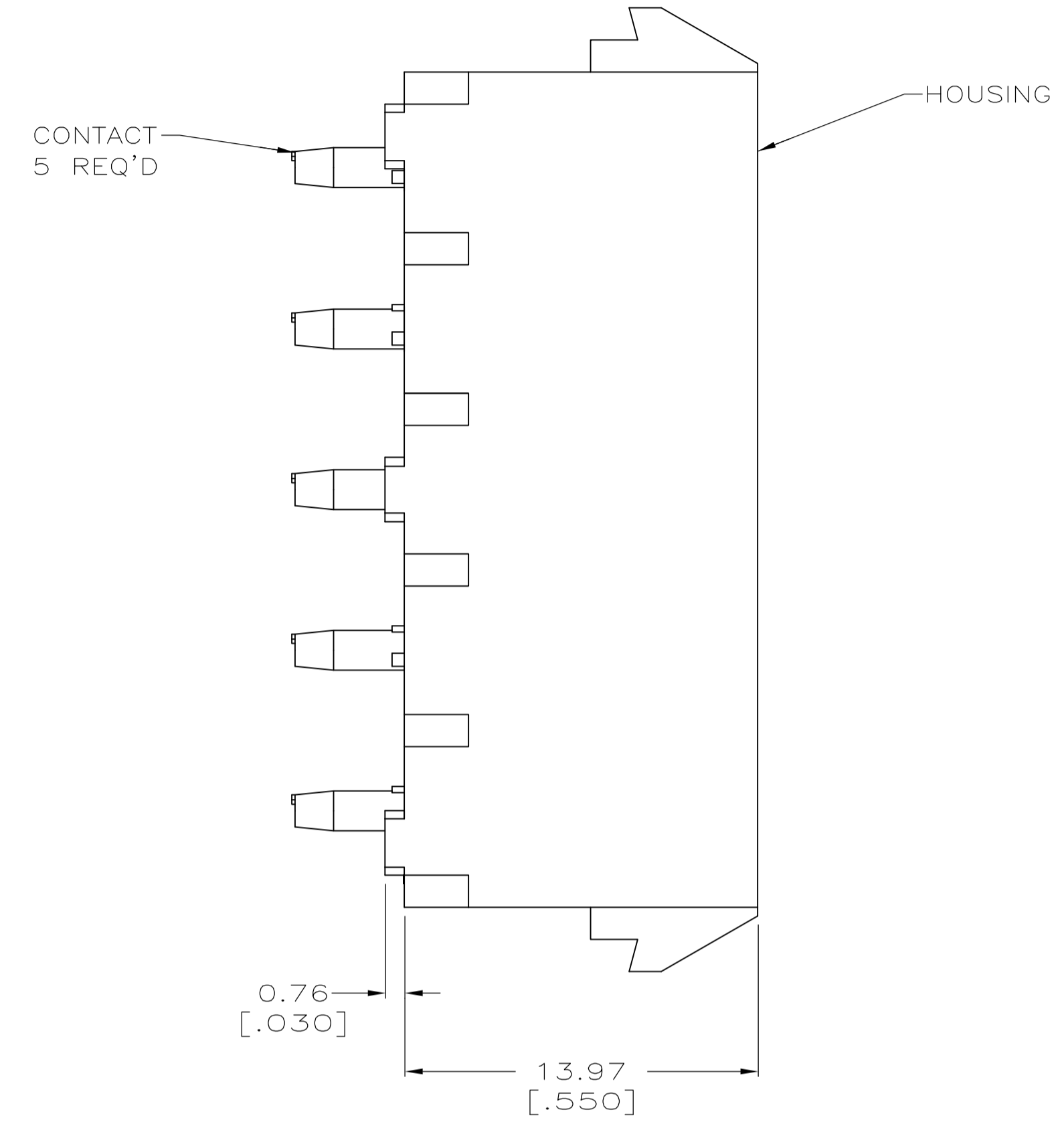
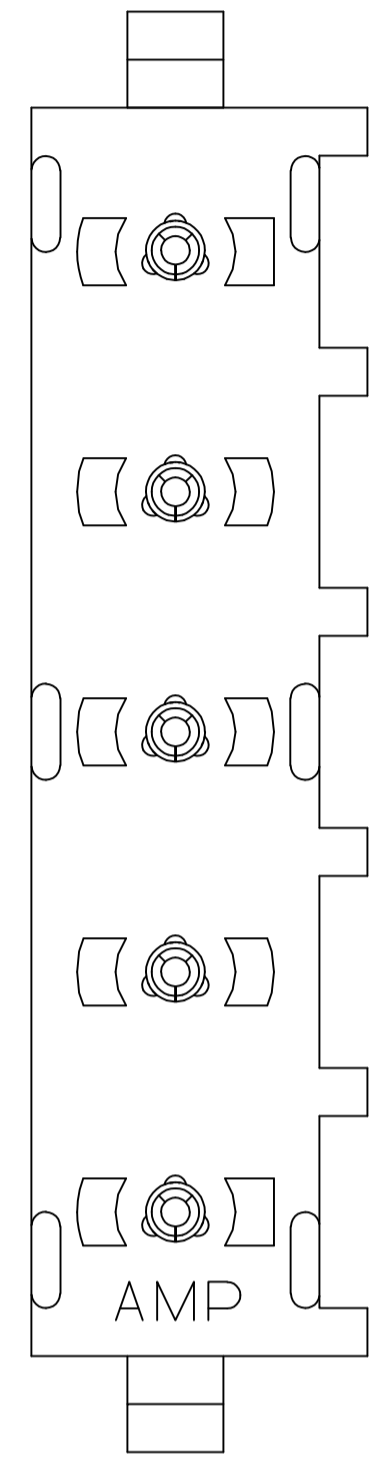
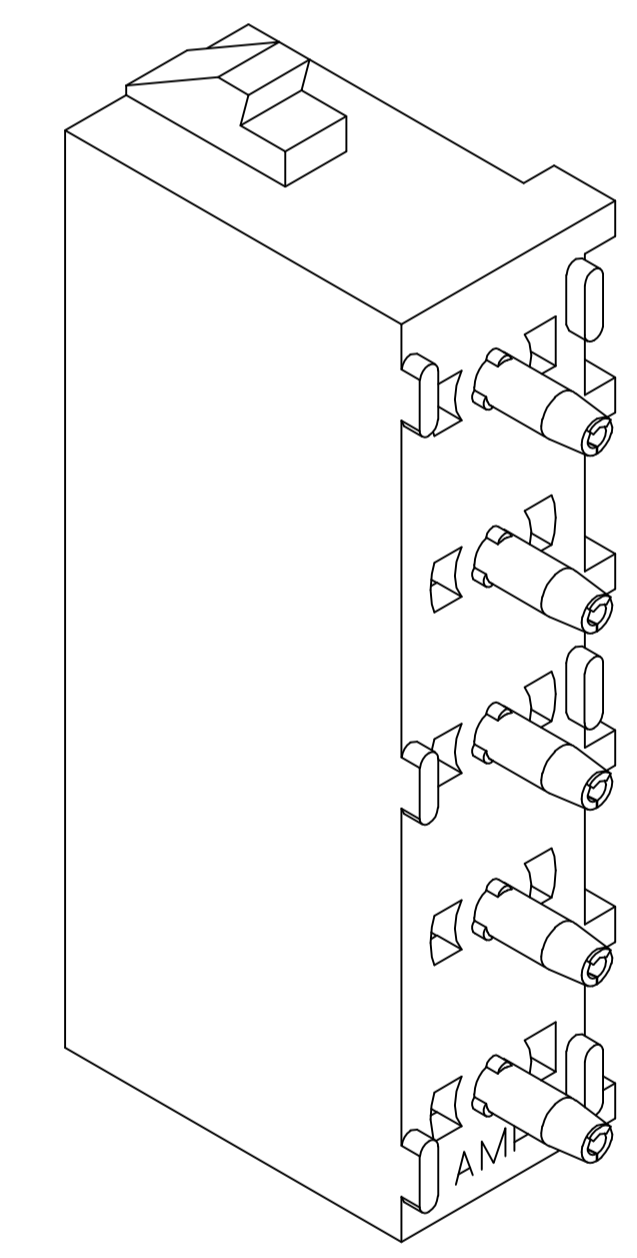
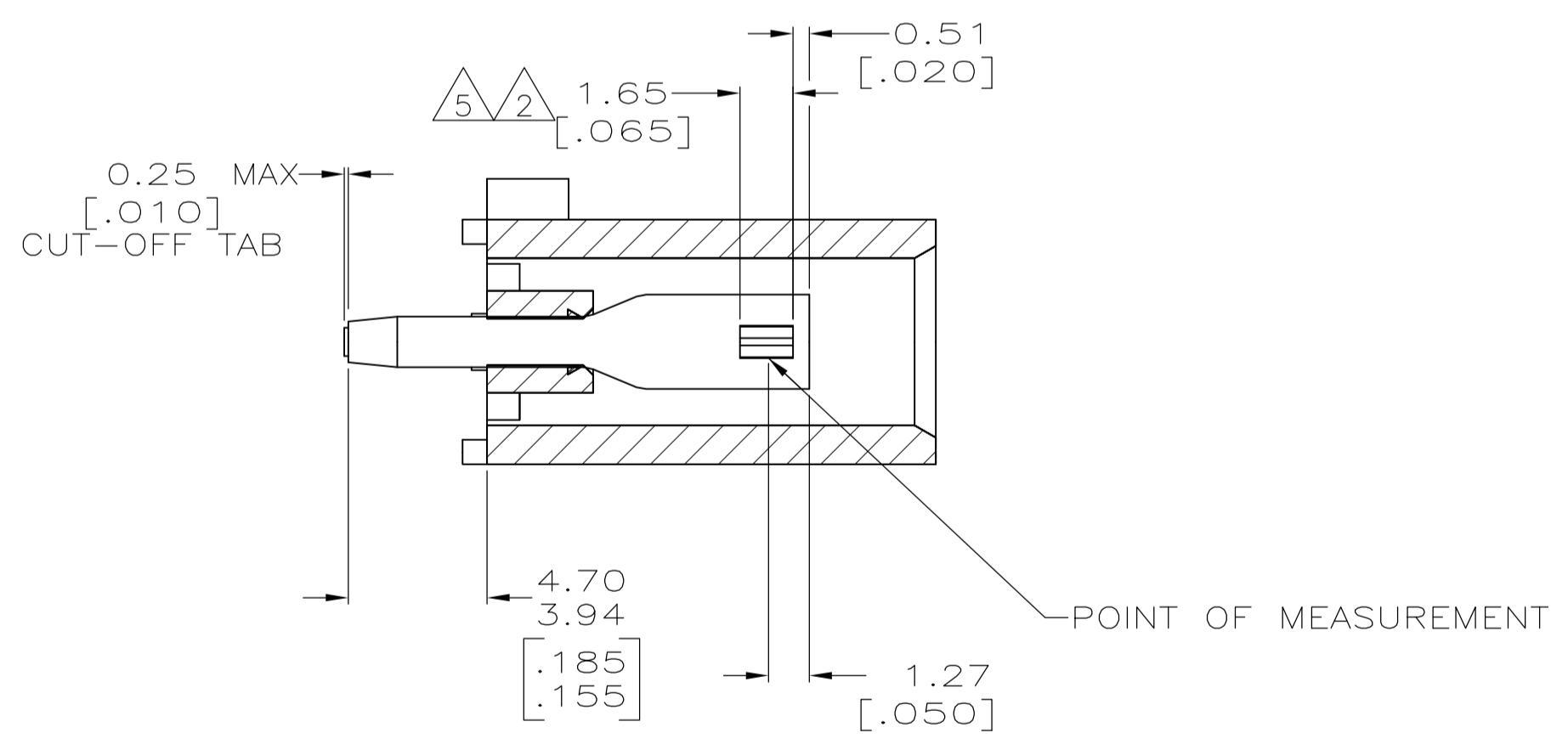

3-DIMENSIONAL MODEL NTS

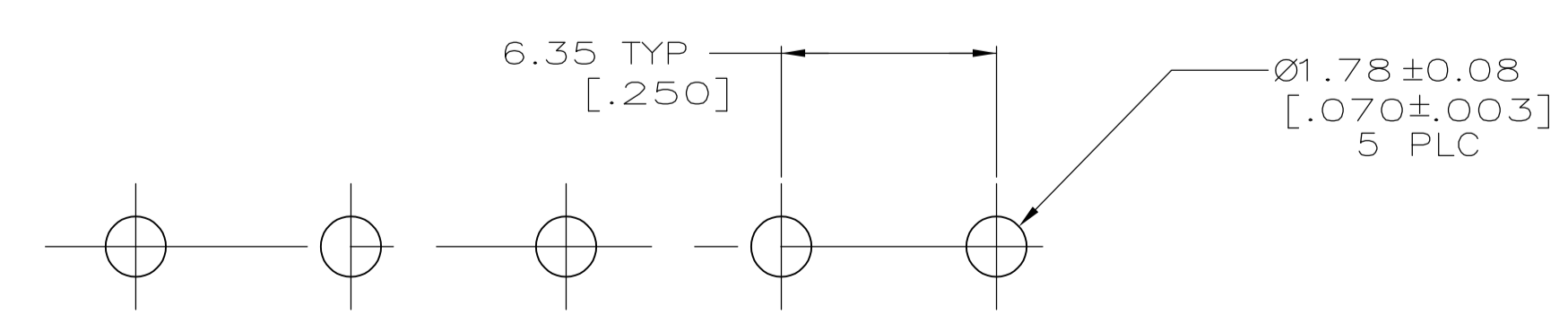

RECOMMENDED MOUNTING HOLE PATTERN FOR 1.57 [.062] THICK P.C. BOARD

MATERIAL	FINISH	HOUSING MATERIAL	PART NUMBER
PHOSPHOR BRONZE, PRE-TIN	NYLON,UL94V-0, BLUE	61-640901-4	
PHOSPHOR BRONZE, PRE-TIN	NYLON,UL94V-0, RED	1-640901-2	
PHOSPHOR BRONZE, GOLD	NYLON,UL94V-0, NATURAL	640901-3	
PHOSPHOR BRONZE, GOLD	NYLON,UL94V-0, NATURAL	640901-2	
PHOSPHOR BRONZE, PRE-TIN	NYLON,UL94V-0, NATURAL	640901-1	
CONTACT MATERIAL AND FINISH	HOUSING MATERIAL	PART NUMBER	

THIS DRAWING IS A CONTROLLED DOCUMENT.		DIN R LEWIS 10-05-98	TE Connectivity	
DIMENSIONS: mm [INCHES]		CHK R SWING 10-05-98	NAME	
TOLERANCES UNLESS OTHERWISE SPECIFIED:		APPV M TRULL 10-05-98	PRODUCT SPEC	
0 PLC ± -	1 PLC ± -	APPLICATION SPEC		
2 PLC ± 0.20[.008]	3 PLC ± -	SIZE		
4 PLC ± -	ANGLES ± 0°30'	CAGE CODE DRAWING NO		
MATERIAL SEE TABLE	FINISH SEE TABLE	WEIGHT	A1 00779 C=640901	RESTRICTED TO
CUSTOMER DRAWING		SCALE 5:1	SHEET 1 OF 1	REV N2