

THIS DRAWING IS A CONTROLLED DOCUMENT FOR AMP INC. IT IS SUBJECT TO CHANGE AND THE CONTROLLING ENGINEERING ORGANIZATION SHOULD BE CONTACTED FOR THE LATEST REVISION.

THIS INFORMATION IS CONFIDENTIAL, AND IS DISCLOSED TO YOU ON CONDITION THAT NO FURTHER DISCLOSURE IS MADE BY YOU TO OTHER THAN AMP PERSONNEL WITHOUT WRITTEN AUTHORIZATION FROM AMP INCORPORATED, HARRISBURG, PA.

NO. 187997-4

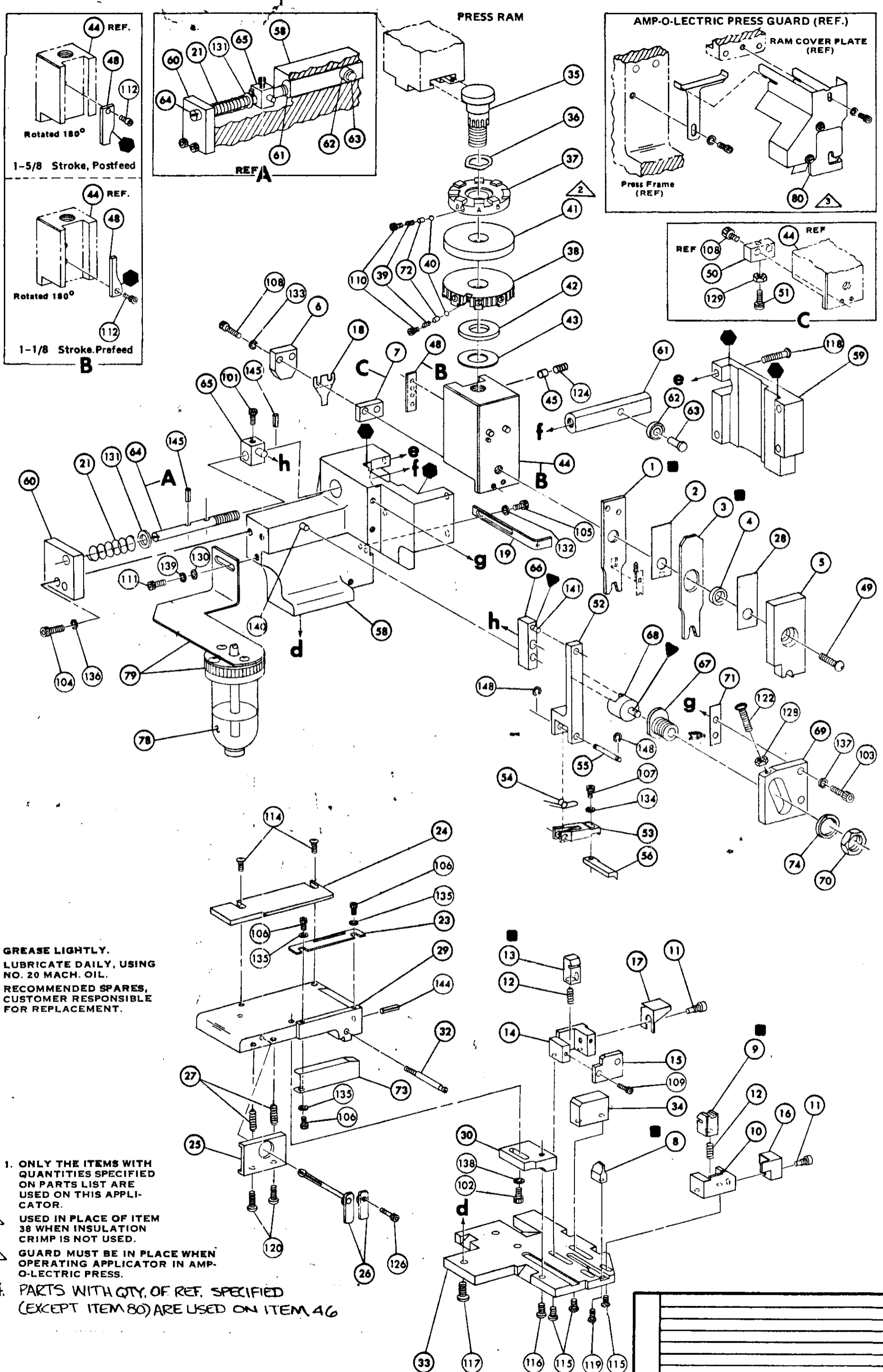

KEY:
 ● GREASE LIGHTLY.
 ● LUBRICATE DAILY, USING NO. 20 MACH. OIL.
 ■ RECOMMENDED SPARES, CUSTOMER RESPONSIBLE FOR REPLACEMENT.

NOTES:
 1. ONLY THE ITEMS WITH QUANTITIES SPECIFIED ON PARTS LIST ARE USED ON THIS APPLICATOR.
 2. USED IN PLACE OF ITEM 38 WHEN INSULATION CRIMP IS NOT USED.
 3. GUARD MUST BE IN PLACE WHEN OPERATING APPLICATOR IN AMP-O-LECTRIC PRESS.
 4. PARTS WITH QTY. OF REF. SPECIFIED (EXCEPT ITEM 80) ARE USED ON ITEM 46.

REQ.	PART NO.	DESCRIPTION	NO.	REQ.	PART NO.	DESCRIPTION	NO.
			162	REF	690517-1	SPACER	71
			161		22594-8	NUT, HEX	70
			160		240628-1	PLATE, ADJUSTMENT	69
			159		240626-1	SHAFT, PIVOT	68
			158		240633-1	BUSHING	67
			157		455680-1	LEVER, INTERMEDIATE	66
			156		240629-1	BLOCK, PIVOT	65
			155		240632-2	SCREW, ADJUSTMENT, FEED ROD	64
			154		240659-3	PIN, CAM ROLLER	63
			153		240658-1	ROLLER, CAM	62
			152		454398-2	ROD, FEED	61
			151		454178-1	GUIDE, FEED ROD	60
			150		454220-1	CAP, HOUSING	59
			149	REF	454485-1	HOUSING	58
REF	21045-3	RING, RETNG "C" (.187 DIA) FEED FINGER PIN	148				57
			147	1	690542-2	PAWL, FEED	56
			146	REF	240624-1	PIN, FEED FINGER	55
REF	5- 21028-1	PIN, SLTD SPRING (.125 DIA x .50) ADJ ROD	145	REF	691499-1	SPRING, FEED FINGER	54
1	4- 21028-0	PIN, SLTD SPRING (.093 DIA x .75) S. G. PL	144	REF	690541-1	FINGER, FEED	53
			143	REF	455679-1	LEVER, TERMINAL FEED ARM	52
			142	1	81242-2	BUMPER, HOLDDOWN	51
REF	1- 21030-1	PIN, DOWEL (.187 DIA x .50) LEVER	141	1	690753-1	SPACER, TONKER	50
REF	1- 21030-6	PIN, DOWEL (.187 DIA x 1.25) HOUSING	140	1	7-21007-9	BOLT, CRIMPER	49
1	21024-5	WASHER, LOCK (NO. 10) LUB ASSY	139	1	690602-5	CAM PRE-FEED 1/8 STROKE	48
1	21024-5	WASHER, LOCK (NO. 10) STRIP GUIDE ADJ BLK	138				47
REF	21024-5	WASHER, LOCK (NO. 10) FEED GUIDE ADJ PLATE	137	1	459456-1	APPL BASIC SUB ASSY	46
REF	21024-5	WASHER, LOCK (NO. 10) FEED GUIDE ROD	136	1	690191-1	PLUG, NYLON	45
3	21057-2	WASHER, LOCK (NO. 4) FRONT STRIP GUIDE	135	1	455673-1	RAM	44
1	21024-4	WASHER, LOCK (NO. 8) FEED FINGER	134	1	690125-1	WASHER, LAMINATED	43
2	21024-4	WASHER, LOCK (NO. 8) DEPRESSOR	133	1	690124-1	WASHER, RAM	42
1	21024-4	WASHER, LOCK (NO. 8) STRIPPER	132				41
REF	21899-4	WASHER, FLAT (5/16 DIA) SCREW ADJ	131	2	23241-6	BALL, STEEL	40
1	21899-2	WASHER, FLAT (NO. 10) LUB ASSY	130	2	690170-1	SPRING, COMPRESSION	39
1	21068-5	NUT, HEX MACH (6-32) HOLDDOWN	129	1	690142-1	DISC, INSULATION	38
REF	21068-5	NUT, HEX MACH (6-32) FEED ADJ	128	1	6-690692-3	DISC, WIRE	37
			127	1	22480-5	WASHER, SPRING	36
			126	1	690212-1	POST, RAM	35
	22353-8	SCREW, SHLDR (.187 DIA x .250 LG) DRAG LEVER	125	1	690786-6	SUPPORT, TERMINAL	34
1	21009-2	SCREW, SKT SET (1/4-20 x .25) (NYLOK) RAM	124	REF	455675-1	PLATE, BASE	33
			123	1	690432-3	SCREW, ADJUSTMENT	32
REF	3- 21064-2	SCREW, RD HD MACH (6-32 x 1.50) FEED ADJ	122				31
			121	REF	455689-1	BLOCK, STRIP GUIDE ADJ	30
2	2- 21002-9	SCREW, BTN HD SKT CAP (10-32 x .75) DRAG	120	1	455671-1	PLATE, STRIP GUIDE	29
1	22733-8	SCREW, BTN HD SKT CAP (8-32 x .38) ANVIL	119	1	455688-0	SPACER, F. SHEAR DEPRESSOR	28
REF	2- 21002-9	SCREW, BTN HD SKT CAP (10-32 x .75) CAP	118	2	1-22284-0	SPRING, DRAG	27
REF	1- 24073-9	SCREW, BTN HD SKT CAP (NYLOK) 1/4-20 x .75 HSG	117	1	690546-1	LEVER, DRAG RELEASE	26
REF	2- 21002-7	SCREW, BTN HD SKT CAP (10-32 x .50) S.G. ADJ BLK	116	1	240792-1	DRAG, STOCK	25
4	2- 21002-2	SCREW, BTN HD SKT CAP (8-32 x .50) SHEAR	115	1	6-690504-1	GUIDE, STRIP REAR	24
2	2-21002-2	SCREW, BTN HD SKT CAP (8-32 x .50) R. S. G.	114	1	690438-1	GUIDE, STRIP FRONT	23
			113				22
1	2- 21003-0	SCREW, FLAT HD SKT CAP (6-32 x .50) CAM	112	REF	4- 22284-9	SPRING, FEED RETURN	21
1	3- 21000-4	SCREW, SKT HD CAP (10-32 x .38) LUB ASSY	111				20
2	23030-7	SCREW, SKT HD CAP (6-32 x .25) (NYLOK) C.P. DISC	110	1	690472-1	STRIPPER	19
2	2-21000-8	SCREW, SKT HD CAP (8-32 x .62) DEPRESSOR	109				18
1	2-21000-3	SCREW, HEX HD MACH (8-32 x .31) FEED FINGER	108				17
3	1- 21000-3	SCREW, SKT HD CAP (4-40 x .25) F. STRIP GUIDE	107	1	691667-1	GUARD, CHIP FRONT	16
1	2- 21000-7	SCREW, SKT HD CAP (8-32 x .50) STRIPPER	106				15
REF	3- 21000-7	SCREW, SKT HD CAP (10-32 x .75) FEED ROD G.	105				14
REF	3- 21000-6	SCREW, SKT HD CAP (10-32 x .62) FEED ADJ BLK	104				13
1	3- 21000-4	SCREW, SKT HD CAP (10-32 x .38) S.G. ADJ BLK	103	1	5- 22280-0	SPRING, SHEAR	12
REF	3- 21000-4	SCREW, SKT HD CAP (10-32 x .38) PIVOT BLOCK	102	1	690461-1	STOP, SHEAR	11
REF	455749-1	GUARD ASSY (WINDOW)	80	1	690459-1	HOLDER, SHEAR FRONT	10
1	1-465184-0	LUBRICATOR ASSY	79	1	462006-1	SHEAR, FLOAT FRONT	9
REF	6529-12	OIL SYNTHETIC	78	1	1-458834-1	ANVIL	8
			77		240641-5	SPACER, DEPRESSOR REAR	7
			76	1	2-455889-0	DEPRESSOR, SHEAR REAR	6
			75	1	238011-4	DEPRESSOR, SHEAR FRONT	5
REF	458109-1	WASHER, FLAT, SPECIAL	74	1	1-456135-8	SPACER, TUBULAR, INS CRIMPER	4
1	454877-3	PLATE, STRIP GUIDE COVER	73	1	455688-3	CRIMPER, INSULATION	3
2	690603-1	SPRING, ASSIST	72	1	4-456406-3	SPACER, CRIMPER	2
			71	1	4-456406-3	CRIMPER, WIRE	1

CRIMPING DATA				THIS APPLICATOR WILL APPLY	
PAD LETTER	CRIMP HEIGHT	WIRE SIZE	WIRE STRIP LENGTH		
A	.068	#14		SOC	DIN
B	.059	#16		66578	66577
C	.052	#18		66651	66650
D	NOT	USED			
CRIMP	SIZE	TYPE	FEED	USED ON	
WIRE	.090	F		MACH NO.	
INSULATION	140	0	.500	565435-5	
INSULATION RANGE	WIRE RANGE	APPLICATOR INSTRUCTION #8040			
.105-.135	18-14	REMARKS: AMP-O-LECTRIC PRE-FEED			

J 10150-6987-96	DATE 7-96
H ECA-2723-90	DATE 10-71
G ECA-AT60528	DATE 11-85
F3 REV PER ECN	R 3/11/87 7-77
F2 SUPP BY 466752-2	R 1/26/84 7-2
F1 ADD TEAMS 46650, 66651	R 2/11/84 5-14/80
F REV ITEM 37	R 2/23/84 4/81-78
E ADDED ITEM 66597, 66578	R 1/25/84 1/81-5176
D REV. PER ECN	R 1/25/84 1/81-76
C REV. PER ECN	R 1/25/84 1/81-76
B REV. PER ECN	R 1/25/84 1/81-76
A REV. PER ECN	R 1/25/84 1/81-76
O1 ADDED ITEM 66551 PER ECN	R 1/27/84 1/81-613

I.D. PLATE (REF): 461264-1

SET UP GAGE	LAYOUT NO.	AMP AMP INCORPORATED HARRISBURG, PENNA.
458627-1	679-	
DRAWN 10-29-73	APPROVED 10-31-73	LOC NO. 687997-4
CHANNICE	REV NAME	
CHECKED 5-31-73	REL. 10-31-73	SCALE NONE
K MILLER	REL. 10-31-73	APPLICATOR MINIATURE QUICK CHANGE SIDE-FEED (TYPE VI .062 DIA. PIN & SOC)

LT	REVISION RECORD	ECN	DR	CK	DATE	LT	REVISION RECORD	ECN	DR	CK	DATE
----	-----------------	-----	----	----	------	----	-----------------	-----	----	----	------