

LOC	DIST	REVISIONS			DATE	DWN	APVD
—	—	P	LTR	DESCRIPTION			
		D		CONTACT PIN MATERIAL & PLATING CHANGE	26JUN2014	PS	JK

POS. PER ROW	L±0.4	PART NO.
—	—	—
2	5.08	829706-2 Δ
3	7.62	-3
4	10.16	-4 Δ
5	12.70	-5 Δ
6	15.24	-6 Δ
7	17.78	-7
8	20.32	-8 Δ
9	22.86	-9 Δ
10	25.40	1- -0
11	27.94	1- -1
12	30.48	1- -2 Δ
13	33.02	1- -3
14	35.56	1- -4 Δ
15	38.10	1- -5 Δ
16	40.64	1- -6
17	43.18	1- -7 Δ
18	45.72	1- -8 Δ
19	48.26	1- -9 Δ
20	50.80	2- -0 Δ
21	53.34	2- -1 Δ
22	55.88	2- -2 Δ
23	58.42	2- -3 Δ
24	60.96	2- -4 Δ
25	63.50	2- -5 Δ
26	66.04	2- -6
27	68.58	2- -7 Δ
28	71.12	2- -8 Δ
29	73.66	2- -9 Δ
30	76.20	3- -0 Δ
31	78.74	3- -1 Δ
32	81.28	3- -2
33	83.82	3- -3 Δ
34	86.36	3- -4 Δ
35	88.90	3- -5 Δ
36	91.44	3- -6 Δ
37	93.98	3- -7 Δ
38	96.52	3- -8 Δ
39	99.06	3- -9 Δ
40	101.60	4- -0 Δ
41	104.14	4- -1 Δ
42	106.68	4- -2 Δ
43	109.22	4- -3 Δ
44	111.76	4- -4 Δ
45	114.30	4- -5 Δ
46	116.84	4- -6 Δ
47	119.38	4- -7 Δ
48	121.92	4- -8 Δ
49	124.46	4- -9 Δ
50	127.00	5- 829706-0

Δ	CuZn	CONTACT PIN
GREEN	PBT	PIN HOUSING
FINISH/COLOR	MATERIAL	DESCRIPTION

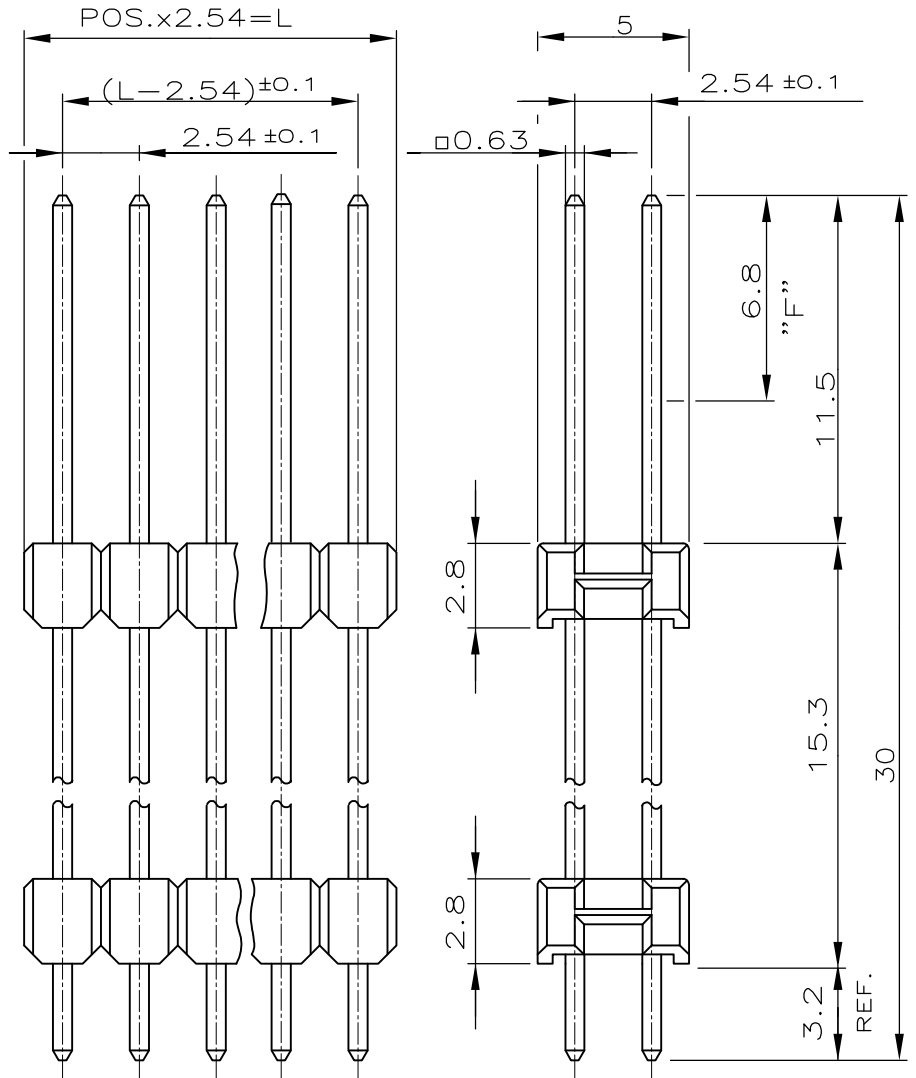

NOTES:

- Δ 1 MATING SIDE: MIN 0.7 μ m PdNi+ MIN 0.1 μ m GOLD FLASH IN ZONE "F" OVER 1.27 μ m NICKEL
SOLDER SIDE: 3.0 TO 5.0 μ m TIN OVER 1.27 μ m NICKEL.
- Δ 2 OBSOLETE PARTS: OBSOLETE CIS STREAMLINING PER D.RENAUD/D.SINISI

THIS DRAWING IS UNPUBLISHED. ALL RIGHTS RESERVED. ABLAGE NR.

DIMENSIONS:

mm

TOLERANCES UNLESS OTHERWISE SPECIFIED:

±0.2

- 0 PLC ± -
- 1 PLC ± -
- 2 PLC ± -
- 3 PLC ± -
- 4 PLC ± -
- ANGLES ± -

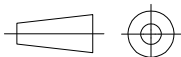

DWN A.HO	08.10.90	MATERIAL SEE TABLE	FINISH SEE TABLE
CHK M.SCHAARSCHMIDT	—		
APVD —	—		
PRODUCT SPEC 108-18012	NAME AMPMODU II STACKING PIN HEADER, DUAL ROW	SIZE A4	CAGE CODE 00779
APPLICATION SPEC —	DRAWING NO C-829706	RESTRICTED TO —	
WEIGHT —	CUSTOMER DRAWING	SCALE 4:1	SHEET 1 OF 1
		REV D	